

产品介绍

使用产品前请仔细阅读本说明书,并妥善保管

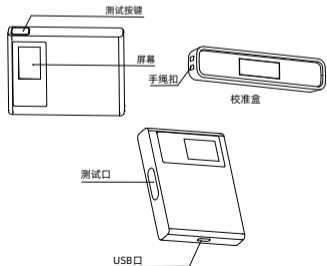

光泽度仪 使用说明书

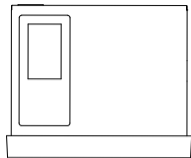

快速使用指南

1. 开机并测量

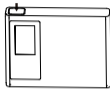

按下按键开机

2. 如何测试

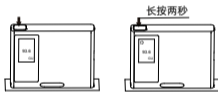

3. 关机

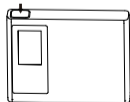

超过1分钟未使用自动关机或长按5秒关机

基本参数

产品名称:	光泽度计
校 准:	自动
测量角度:	60°
测量指标:	光泽度(GU)
测量口径:	23*7mm
测量量程:	0-200GU
分 度 值:	1GU
测量稳定度*:	1
电池容量:	单次充电可连续测量5000次
屏 幕:	全彩显示屏, 135*240, 1.14英寸
接 口:	USB
工作温度:	0-40°C
湿 度:	小于85%, 不结露
配 件:	USB数据线, 挂绳, 说明书, 校准标准版
重 量:	80g
尺 寸:	84mm*70mm*17mm

*连续测量30次标准偏差,当测量值小于100GU时,用绝对值评价;
当测量值大于100GU时,用百分比评价。

【参数如有修改, 恕不另行通知】

警告

- 请勿尝试拆卸或更换仪器内部零件如需服务请联系代理商或官方客服。
- 请勿将仪器放置于热源或直接暴露在炉火旁。
- 若任何液体不小心进入仪器请立即关闭仪器电源。
- 本产品及内部零件如被儿童误食可能导致窒息等危险。

合格证
已检验

保修说明

本产品售后服务严格依据《中华人民共和国消费者权益保护法》《中华人民共和国产品质量法》实行售后三包服务,服务内容如下:

- 1、自您签收日起7日内,本产品出现《产品性能故障表》所列性能故障的情况,经由本司售后服务中心检测确定,可免费享受退货或换货服务;
- 2、自您签收日起8-15日内,本产品出现《产品性能故障表》所列性能故障的情况,经由本司售后服务中心检测确定,可免费享受换货或维修服务;
- 3、自您签收日起12个月内,本产品出现《产品性能故障表》所列性能故障的情况,经由本司售后服务中心检测确定,可免费享受维修服务。

提示信息

因运输过程中需用包装箱保证产品运输安全,建议自签收日起至少保留包装箱30天。

非保修条例

- 1、未经授权维修误用、碰撞、疏忽、滥用、进液、事故改动使用非本产品配件,或撕毁涂改标签防伪标记;
- 2、已超过三包有效期;
- 3、因不可抗力造成的破坏;
- 4、不符合《产品性能故障表》所列性能故障的情况;
- 5、因人为原因导致非本产品及其配件产生《产品性能故障表》所列性能故障。

性能故障表

名称	性能故障
光泽度仪	1.仪器开关卡滞,不能正常开关 2.仪器显示器无法正常显示 3.测量光源不亮

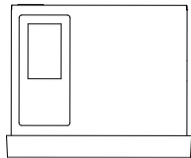

Gloss Meter Instruction Manual

Product introduction

Please read this manual carefully before using the product.

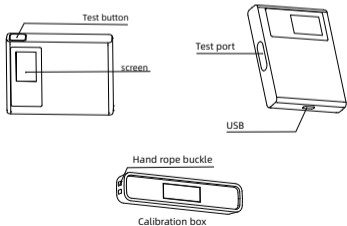

Quick guide

1. Start up and measure

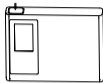

Press the key to start

2. How to test

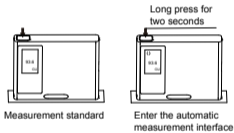

3. Shut down

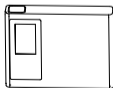

Instrument will switch off automatically if it is not used for more than one minute or press test button for 5s to switch it off.

Parameters

Product name:	Gloss Meter
Calibration:	Automatic
Measuring angle:	60°
Measurement index:	Gloss(GU)
Test Aperture:	23*7mm
Measuring range:	0-200GU
Index value:	1GU
Display Accuracy [※] :	1
Battery capacity:	5000 consecutive measurements can be made for single charge
Screen:	Full color display 135*240, 1.14inch
Charging interface:	USB
Working temperature:	0-40°C
Humidity:	Less than 85%, no condensation
Standard Accessories:	USB cable, lanyard, manual, calibration tile
Weight:	80g
Size:	84mm*70mm*17mm

※ Continuously measure the standard deviation for 30 times. When the measured value is less than 100gu, use the absolute value to evaluate; When the measured value is greater than 100gu, it is evaluated by percentage

【Parameters are subject to change without notice】



Warranty instructions

Reminder

It is recommend that keep the packing box for at least 30 days as the packing box is required to ensure the safety of transportation.

Non warranty regulations

- 1.Unauthorized repair,misuse,accident,modification,use of non-official accessories.
- 2.Instrument is out of warranty.
- 3.Damage caused by force.
- 4.Not the performance failure listed in the product performance failure table.
- 5.Performance failure caused by human factors.

Warning

- Do not attempt to disassemble or replace any part of the equipment. Please contact the agent or official customer service for after sales service.
- Do not place the equipment near heat source or directly expose to the fire.
- If any liquid enters the equipment, please power off the equipment immediately.
- This product contains small parts.It may cause suffocation and other hazards,if swallowed by children,

Product performance failure table

Name	Performance failure
Gloss Meter	1.The instrument switch is stuck and cannot be switched normally 2.The instrument display fails to display normally 3.The measuring light source is not on